

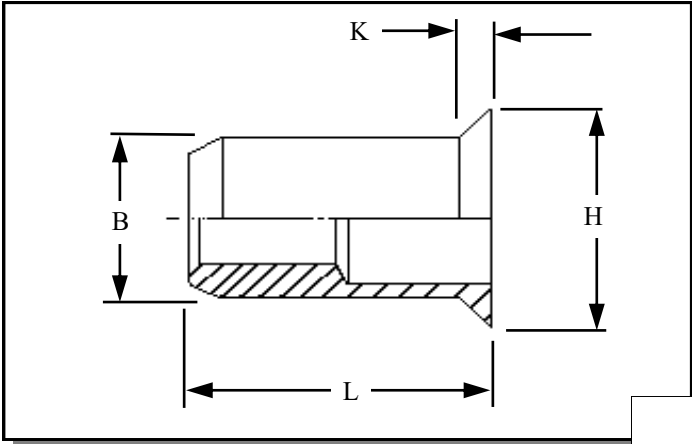

RIVETNUT TECHNOLOGY SYSTEMS LIMITED

RCOI-CD IN STAINLESS STEEL



Round Countersunk head
open ended Rivetnuts for
material up to
6.50 mm thick

All dimensions in mm
Material :- Stainless Steel
(AISI 304cu)
Finish :- Self Colour

R.T.S. SALES LINE
01296 330331

TECHNICAL DATA SHEET

| THREAD SIZE | GRIP RANGE | HOLE SIZE -0.0 +0.10 | BODY DIA "B" | HEAD DIA "H" ± 0.10 | LENGTH "L" | "K" | PART NUMBER |
|-------------|--------------|-------------------------|-----------------|---------------------------|---------------|------|-----------------|
| M4 | 1.20 to 3.00 | 6.10 | 6.00 | 9.00 | 12.00 | 1.00 | RCOI-04030-CD |
| M5 | 1.20 to 3.50 | 7.10 | 7.00 | 9.00 | 12.00 | 1.00 | RCOI-05035-CD |
| M6 | 1.70 to 4.50 | 9.10 | 9.00 | 12.00 | 17.00 | 1.50 | RCOI-06045-CD |
| | 4.50 to 6.50 | | | | 19.00 | | RCOI-06065-CD * |
| M8 | 1.70 to 4.50 | 11.10 | 11.00 | 14.00 | 17.50 | 1.50 | RCOI-08045-CD |
| | 4.50 to 6.50 | | | | 19.50 | | RCOI-08065-CD |
| M10 | 1.70 to 4.50 | 13.10 | 13.00 | 16.00 | 22.50 | 1.50 | RCOI-10045-CD13 |

* Non-stock item Minimum order quantity's may apply after depletion of stock

For additional information and technical support please contact R.T.S. technical sales department . R.T.S. reserve the right to change specifications at any time . Information given is for guidance only and should not be used for specific design criteria without reference to our application engineers.