

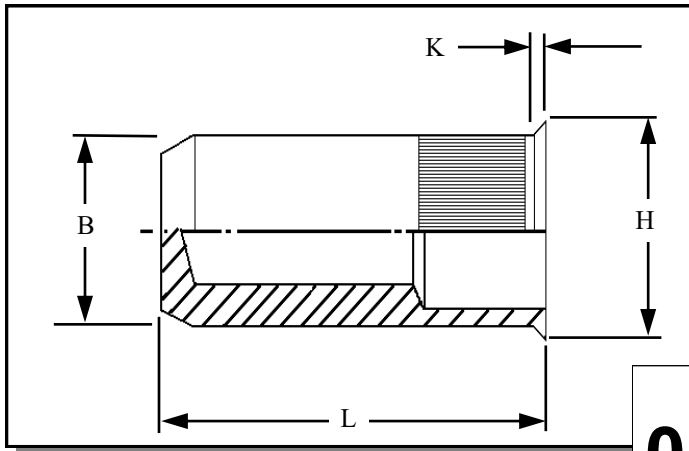

# RIVETNUT TECHNOLOGY SYSTEMS LIMITED

## KCCI IN STAINLESS STEEL

Knurled C.S.K. head  
closed end Rivetnuts for  
material up to 6.80 mm thick



All dimensions in mm  
Material :- A2 Stainless Steel  
Finish :- Self colour

**R.T.S. SALES LINE**  
**01296 330331**

**TECHNICAL DATA SHEET**

THREAD SIZE	GRIP RANGE	HOLE SIZE -0.0 +0.10	BODY DIA "B"	HEAD DIA "H" ± 0.10	LENGTH "L"	"K"	PART NUMBER
M3	1.00 to 1.70 1.10 to 2.30 1.80 to 3.00	5.10	5.00	6.80	11.30 11.90 12.50	1.00	KCCI-03017 KCCI-03023 KCCI-03030
M4	1.00 to 2.10 1.30 to 2.90 2.00 to 3.70	6.10	6.00	7.80	15.20 16.00 16.80	1.00	KCCI-04021 KCCI-04029 KCCI-04037
M5	1.00 to 2.50 1.50 to 3.50 2.50 to 4.50	7.10	7.00	8.80	17.50 18.50 19.50	1.00	KCCI-05025 KCCI-05035 KCCI-05045
M6	1.00 to 2.50 1.50 to 3.50 2.50 to 4.50 3.50 to 5.50	9.10	9.00	10.80	20.90 21.90 22.90 23.90	1.00	KCCI-06025 KCCI-06035 KCCI-06045 KCCI-06055
M8	1.50 to 3.00 1.80 to 4.20 3.00 to 5.40 4.00 to 6.50	11.10	11.00	13.80	24.50 25.70 26.90 28.10	1.50	KCCI-08030 KCCI-08042 KCCI-08054 KCCI-08065
M10	1.50 to 3.70 2.00 to 5.20 4.00 to 6.80	13.10	13.00	15.80	31.90 33.40 34.90	1.50	KCCI-10037 KCCI-10052 KCCI-10068
M12	2.00 to 4.20	16.10	16.00	19.80	34.50	2.00	KCCI-12042

For additional information and technical support please contact R.T.S. technical sales department . R.T.S. reserve the right to change specifications at any time . Information given is for guidance only and should not be used for specific design criteria without reference to our application engineers.